

Optimum M4230

GSM/GPRS TERMINAL INSTALLATION GUIDE



COMPLIANCE

Changes or modifications not expressly approved by the party responsible for compliance could void the user's authority to operate the equipment.

- FCC Part 15
This device complies with Part 15 of the FCC Rules. Operation is subject to the following two conditions: (1) this device may not cause harmful interference, and (2) this device must accept any interference received, including interference that may cause undesired operation. The user is cautioned that changes or modifications to the product(s) identified in this manual unless expressly approved by Hypercom could void the user's authority to operate these product(s).
- CE (Select Models)
 - IC: 1204B-0708270338
 - EN 55022 / EN 550024 / EN 60950
- IEC 60950-1
 - C-tick
 - UL/cUL Listed (UL 60950)
- PCI-PED
 - RoHS
 - WEEE

Note: This equipment has been tested and found to comply with the limits for a Class A digital device, pursuant to Part 15 of the FCC Rules. These limits are designed to provide reasonable protection against harmful interference when the equipment is operated in a commercial environment. This equipment generates, uses and can radiate radio frequency energy and, if not installed and used in accordance with the instruction manual, may cause harmful interference to radio communications. Operation of this equipment in a residential area is likely to cause harmful interference in which case the user will be required to correct the interference at his own expense.

Optimum M4230

GSM/GPRS TERMINAL INSTALLATION GUIDE



 Optimum[®]M₄₂₃₀

World Headquarters:

Hypercom Corporation: 8888 E. Raintree Dr., Suite 300, Scottsdale, AZ 85260 USA | Tel: +1.480.642.5000 | Fax: +1.480.642.4655

© 2007 Hypercom Corporation, all rights reserved. Hypercom and Optimum and Design are registered trademarks of Hypercom Corporation. The Hypercom logo is a trademark of Hypercom Corporation. All other products or services mentioned in this document are trademarks, service marks, registered trademarks or registered service marks of their respective owners. 940546-001 Rev. A 01/08



www.hypercom.com

Optimum M4230 GSM/GPRS Terminal Installation Guide

Equipment Check List →

⚠ WARNING:

- Do not use if visibly damaged.
- Do not expose to temperatures above 140 °F or 60 °C.
- Do not disassemble.
- Do not incinerate or crush.
- Keep out of reach of children and pets.



Optimum M4230



A/C Power Adapter

The *Optimum M4230 GSM/GPRS Terminal Installation Guide* provides basic setup information. Your device also comes pre-installed with a Lithium Ion Battery Module (7.4V - 1.88Ah). Once fully charged, the battery can complete more than 200 transactions before requiring another charge.

Note: Charge the battery for 2-4 hours before initial use of the terminal. Charging indicator turns green when terminal battery is fully charged.

Additional accessories are available for purchase. Contact your Hypercom Sales Associate for specific options and regional availability.

Note: Images within this guide may not exactly match your device.

Battery Installation



Turn the terminal over. Remove the battery by squeezing the inset on the right side of battery (as shown).



Remove and discard the plastic covering surrounding the battery. Re-insert the battery. Note: Connect power and charge battery 2-4 hours before Power On. Indicator light turns green when fully charged.

Power Connection



Turn the terminal over to display labeled ports (as shown):
- POWER port = A/C Power Adapter & Power Cord
- SERIAL port = RS232 cable



Insert A/C Power Adapter into POWER port (as shown). Insert other end of the Power Cord into the wall receptacle. Battery starts to charge.

Power On/Off



Turn the terminal over. To Power On/Off the terminal, press and hold the blue FUNCTION key until you hear a beep (approximately 5 seconds).

Receipt Paper Installation



With your fingers, open the printer cover (as shown).



Drop paper roll into paper holder (as shown). Pull paper (as shown) & close printer cover.

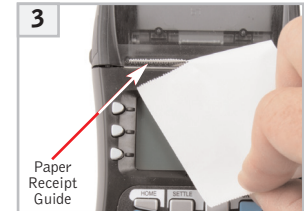

Pull & tear paper against the paper receipt guide. Operate terminal as normal.

Swipe Your Credit Card



Swipe credit card through the card reader with a downward or upward motion (as shown).

Insert Your Smart Card



Insert smart card (gold chip side up) into the smart card reader (as shown).

Clean Your Device



Apply water or plastic-safe cleaner onto a soft, lint free cloth and gently wipe terminal.

Accessories Available



Optimum M4230
(P/N# 010341-001R
For North America Region)



Optimum M4230
(P/N# 010341-002R
For EMEA & Asia Region)



Optimum M4230
(P/N# 010341-007R
For North America Region)



Docking Station with Dial
(P/N# VE018-2006)



Docking Station
(P/N# VE018-2007)

Regional Specific



A/C Power Adapter
(P/N# 870075-xxx)



Lithium Ion Battery Module
(P/N# 400037-001)



Paper Roll
(P/N# 710015-003)



Privacy Shield
(P/N# 040348-001)



Optimum Developer's Toolkit
(P/N# 010305-xxx)